

The advertisement features a collection of BOSFOR gas springs of various sizes and finishes, including chrome and silver. They are arranged diagonally across a dark, textured background. A white rectangular box in the upper right contains the brand name 'BOSFOR' in a large, bold, blue sans-serif font, with 'GAS SPRINGS' in a smaller, blue sans-serif font below it. A vertical red-to-black gradient bar is positioned on the right side of the image.

BOSFOR
GAS SPRINGS

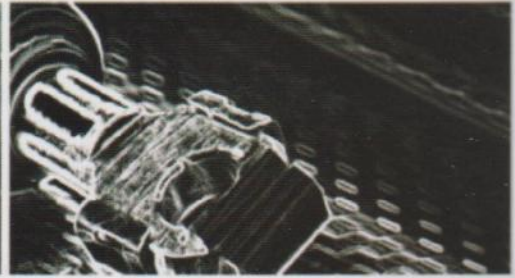

CONTENT

BOSFOR
GAS SPRINGS



1.1	TECHNICAL INSTRUCTIONS OF GAS SPRINGS	3
1.2	CALCULATION OF GAS SPRINGS FORCE	4
1.3	STROKE/FORCE VARIATIONS	5
2.1	6/15 STANDART TYPE GAS SPRINGS	6
2.2.	8/18 STANDART TYPE GAS SPRINGS	7
2.3	10/21 STANDART TYPE GAS SPRINGS	8
2.4	10/22 STANDART TYPE GAS SPRINGS	9
2.5	10/27 STANDART TYPE GAS SPRINGS	10
2.6	14/27 STANDART TYPE GAS SPRINGS	11
2.7	LOCKABLE TYPE GAS SPRINGS (ELASTIC)	12
2.8	LOCKABLE TYPE GAS SPRINGS (RIGID)	13
3.1	METAL END FITTINGS	14
3.2	PLASTIC END FITTINGS	24
3.3	MECHANISMS FOR LOCKABLE TYPE GAS SPRINGS	30

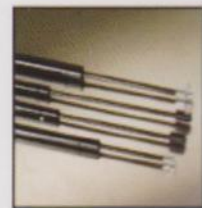



1.1 TECHNICAL INSTRUCTIONS OF GAS SPRINGS

BOSFOR
GAS SPRINGS

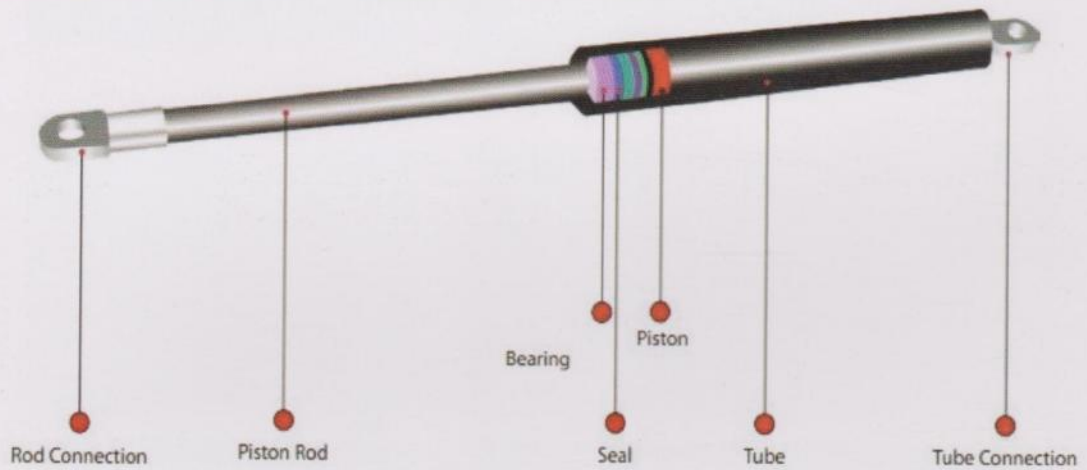

TECHNICAL SPECIFICATIONS OF NEWTONE GAS SPRINGS	
CYLINDER COATING FILM THICKNESS	40+/-10 (micron)
PISTON ROD SURFACE SMOOTHNESS	Max 0.10 Ra
PISTON ROD SURFACE HARDNESS	Min 450 Hv
NITRATION DEEPPNESS	25-30 (micron)
TUS TEST	Min 300 (hour)
PERFOMANCE TEST	Min 10 km stroke



FORCE-STROKE DIAGRAM

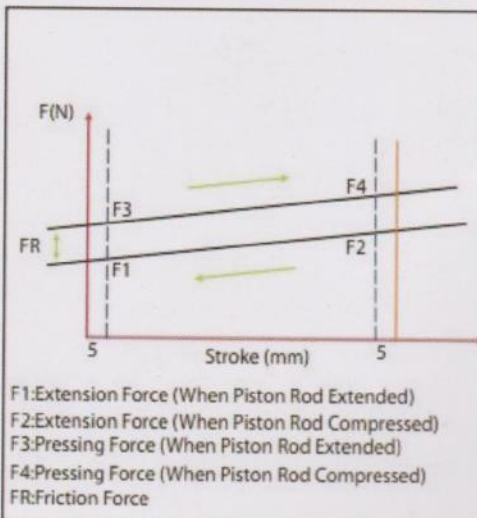

TEMPERATURE vs FORCE VARIATION GRAPH

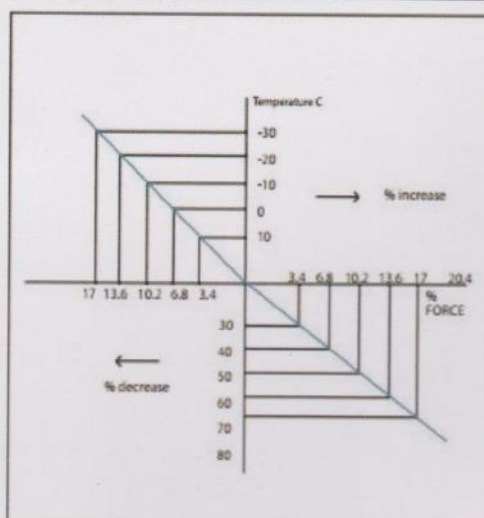

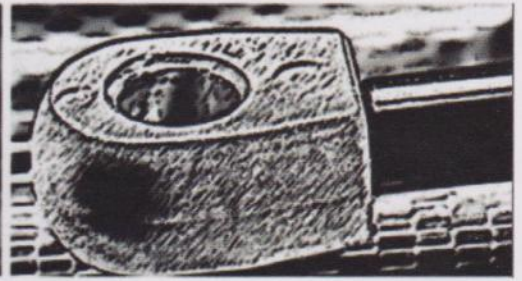
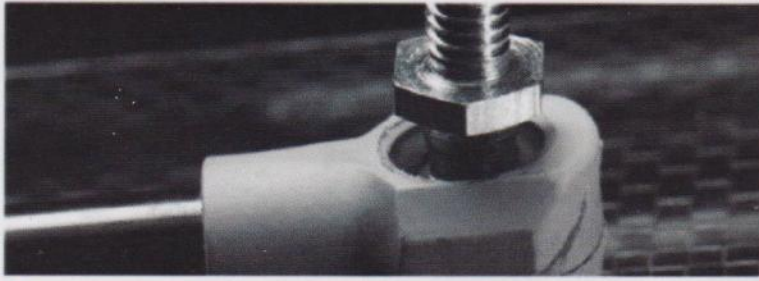

1.2 CALCULATION OF GAS SPRINGS FORCE

BOSFOR
GAS SPRINGS

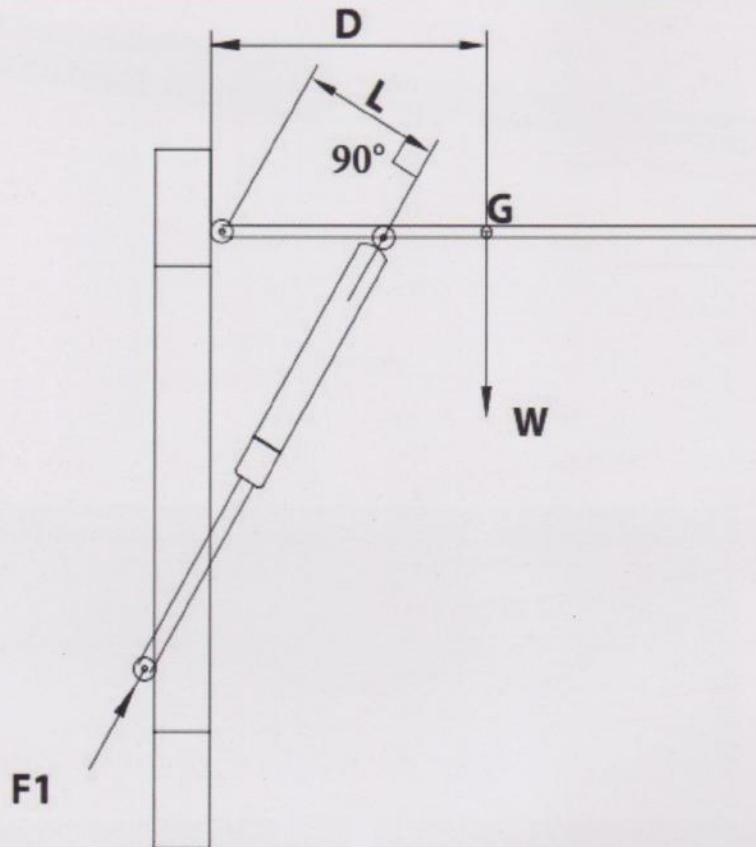

CALCULATION TABLE

$$F1 = \frac{W * D}{X * L}$$

F1 = GAS SPRING FORCE

G = CENTRE OF GRAVITY

W = WEIGHT OF FLAP

D = HORIZONTAL DISTANCE FROM CENTRE OF GRAVITY TO PILOV CENTRE

X = QUANTITY OF NEWTONE GAS SPRING

L = DISTANCE FROM THE GAS SPRING TO PILOV CENTRE

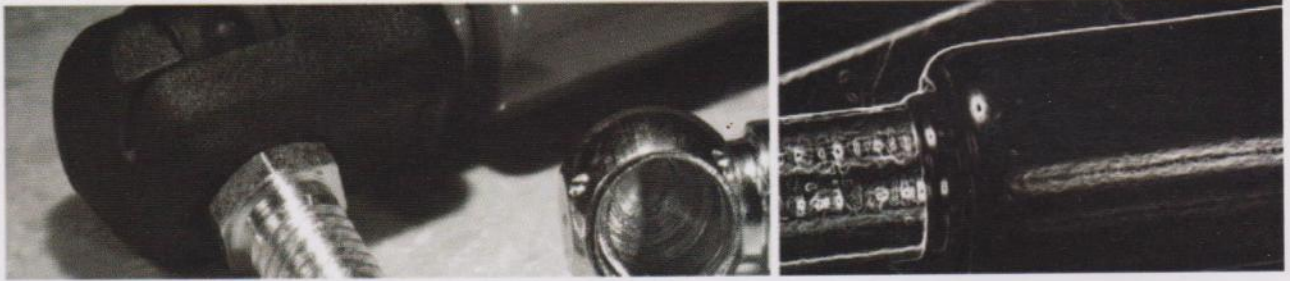

1.3
STROKE/FORCE VARIATIONS

BOSFOR
GAS SPRINGS

STROKE/FORCE DIAGRAM BASED ON ROD AND TUBE DIAMETRES					
Rod Diameter	Tube Diameter	Force Min/Max (N)		Maximum Stroke	Fr Max (N)
6	15	50	400	200	50
8	18	100	800	300	60
10	21	150	1000	500	80
10	22	150	1100	500	80
10	27	150	1200	500	80
14	27	500	2000	500	80

GAS SPRINGS

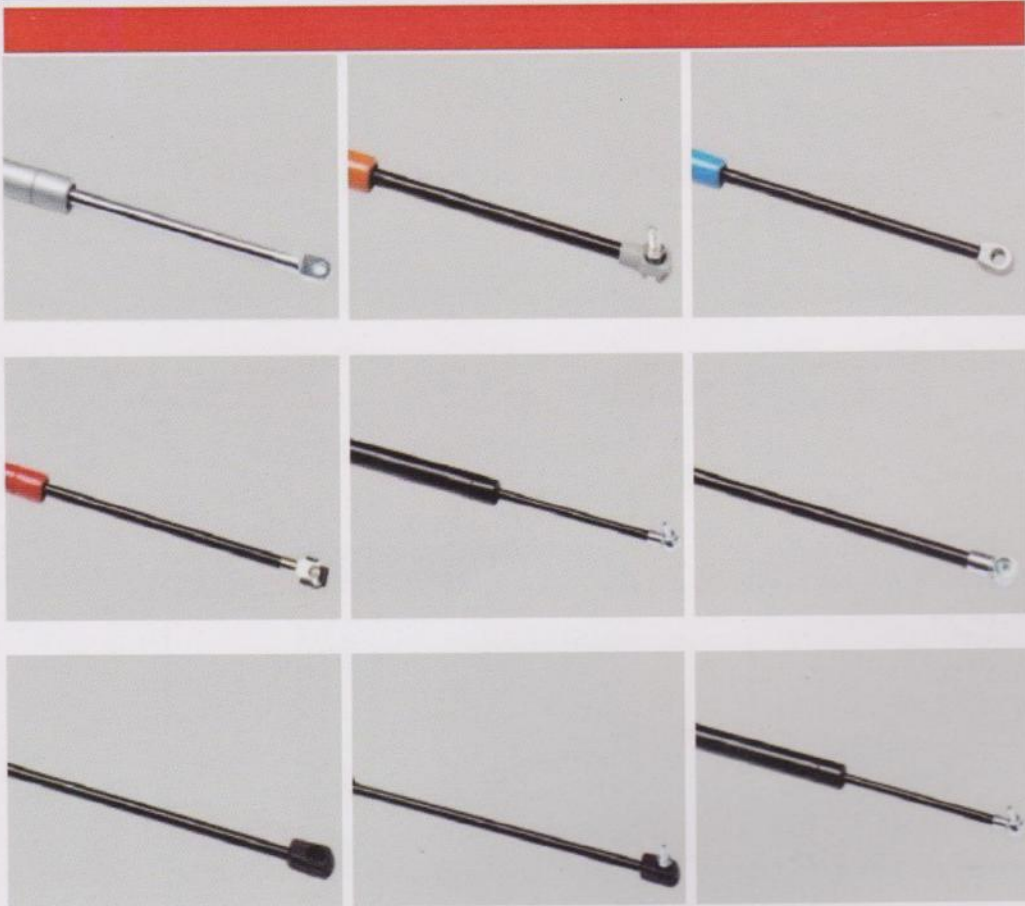



2.1
6/15 STANDARD TYPE GAS SPRINGS

BOSFOR
GAS SPRINGS

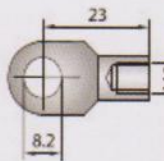
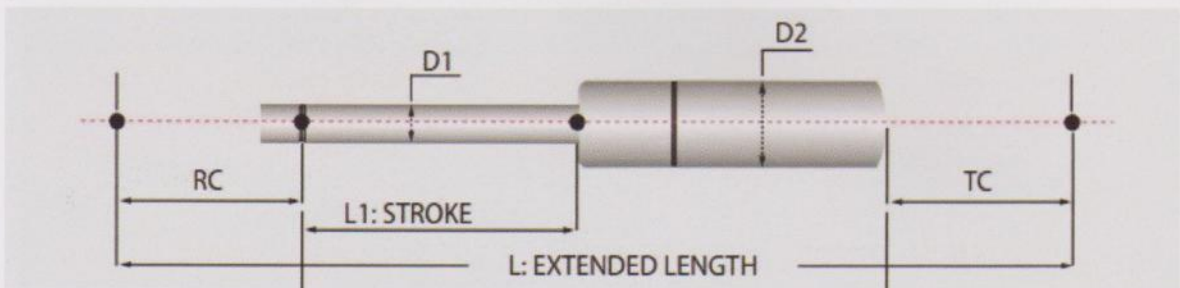

RC 14-103-00

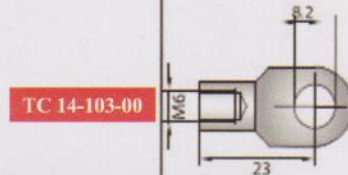

TC 14-103-00

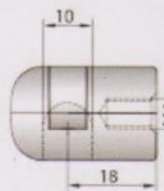

RC 03-200-03



TC 03-200-03

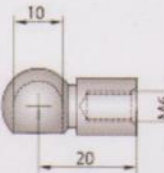

RC 13-106-00

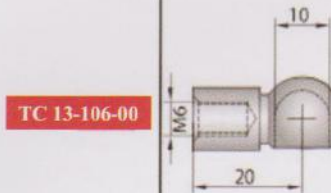

TC 13-106-00

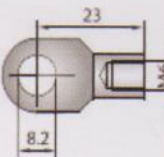

14-103-00

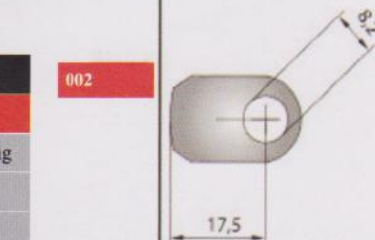

002

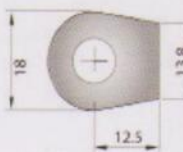

001



001

ORDER EXAMPLE

001-6-15-450-275-350-001

001	Rod connection end fitting
6	Rod diameter
15	Tube diameter
450	Force in Newtons
275	L1: Stroke in mm
350	L: Extended length in mm
001	Tube connection end fitting



**2.2
8/18 STANDARD TYPE GAS SPRINGS**

BOSFOR
GAS SPRINGS

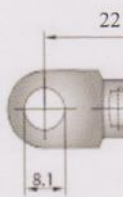
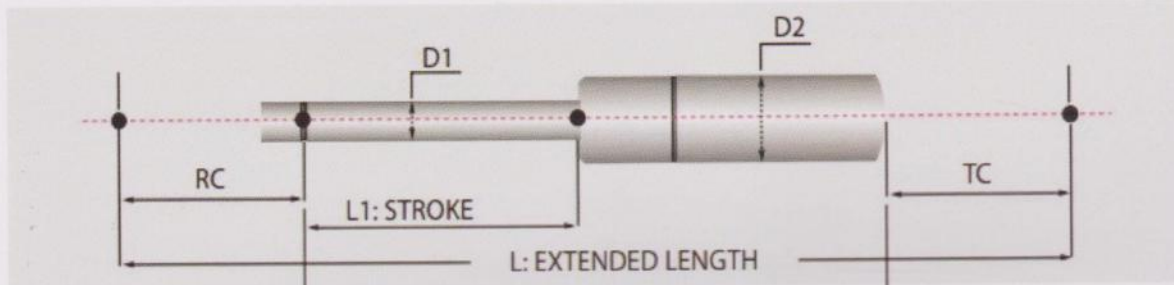

RC 14-103-01

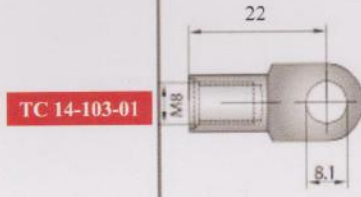

TC 14-103-01

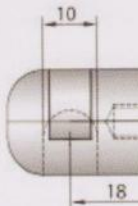

RC 03-200-03

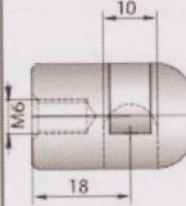

TC 03-200-03

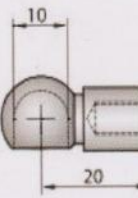

RC 13-106-00

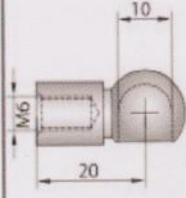

TC 13-106-00

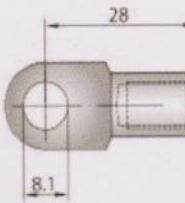

14-103-01

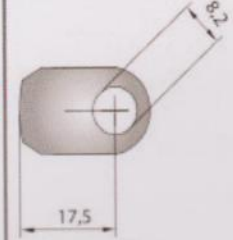

002

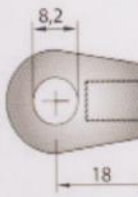

09-253-31

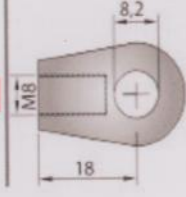

09-253-31

ORDER EXAMPLE	
1410301-8-18-450-275-350-002	
1410301	Rod connection end fitting
8	Rod diameter
18	Tube diameter
450	Force in Newtons
275	L1: Stroke in mm
350	L: Extended length in mm
002	Tube connection end fitting



2.3
10/21 STANDARD TYPE GAS SPRINGS

BOSFOR
GAS SPRINGS

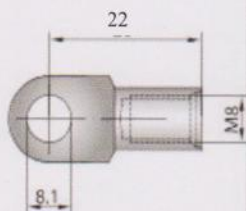
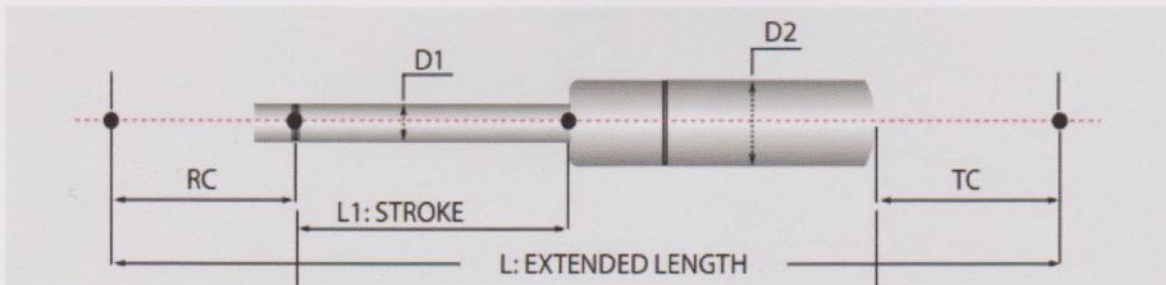

RC 14-103-01

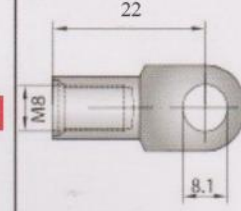

TC 14-103-01

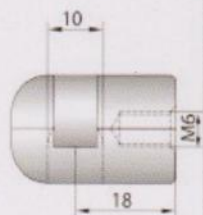

RC 03-200-03

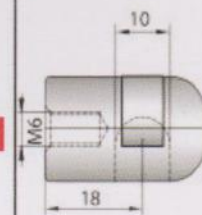

TC 03-200-03

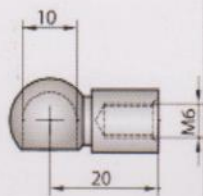

RC 13-106-00

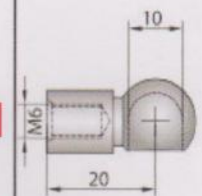

TC 13-106-00

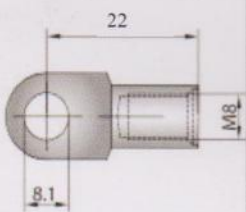

14-103-01

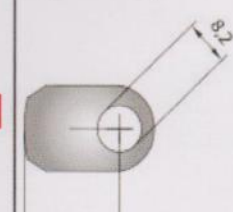

002

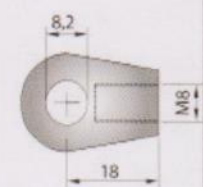

09-253-31

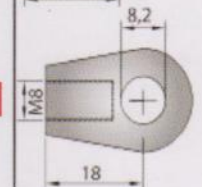

09-253-31

ORDER EXAMPLE

131060-10-21-550-275-350-200

131060	Rod connection end fitting
10	Rod diameter
21	Tube diameter
450	Force in Newtons
275	L1: Stroke in mm
350	L: Extended length in mm
002	Tube connection end fitting



2.4 10/22 STANDARD TYPE GAS SPRINGS

BOSFOR
GAS SPRINGS

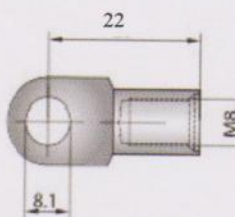
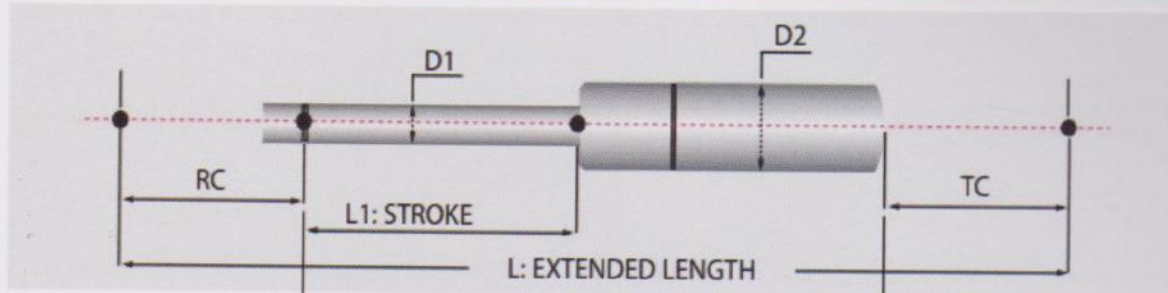

RC 14-103-01

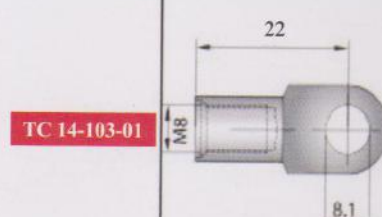

TC 14-103-01

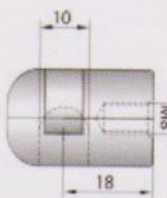

RC 03-202-03

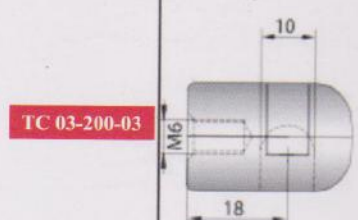

TC 03-200-03

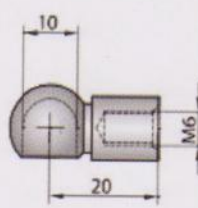

RC 13-106-00

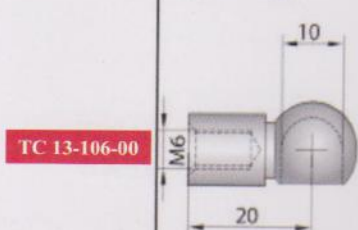

TC 13-106-00

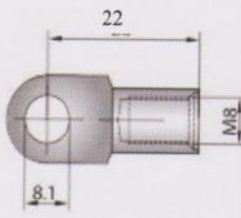

14-103-01

ORDER EXAMPLE

1310600-10-22-550-275-350-002		
1310600	Rod connection end fitting	002
10	Rod diameter	
22	Tube diameter	
450	Force in Newtons	
275	L1: Stroke in mm	
350	L: Extended length in mm	
002	Tube connection end fitting	09-253-31

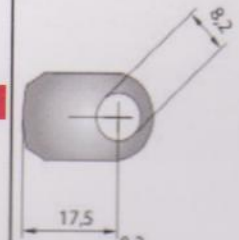

002

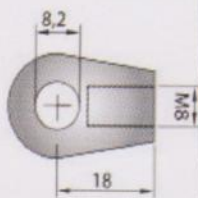

09-253-31

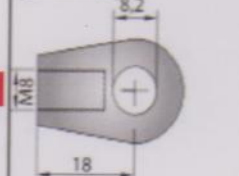

09-253-31



**2.5
10/27 STANDARD TYPE GAS SPRINGS**

BOSFOR
GAS SPRINGS

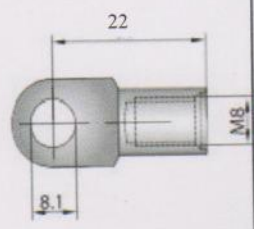
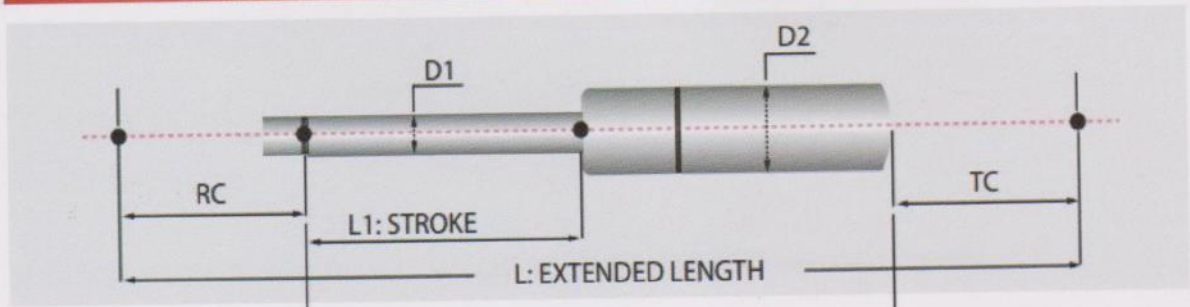

RC 14-103-01

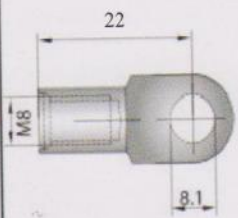

TC 14-103-01

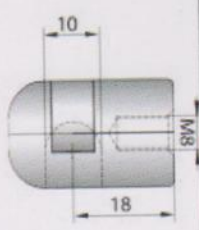

RC 03-202-03

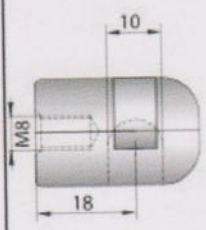

TC 03-202-03

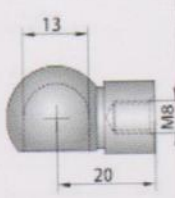

RC 13-108-01

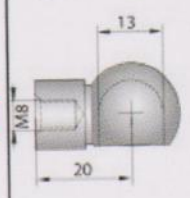

TC 13-108-01

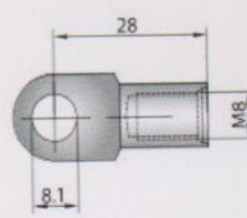

14-103-01

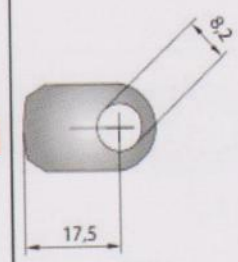

002

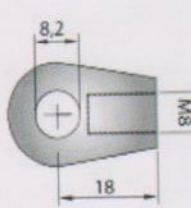

09-253-31

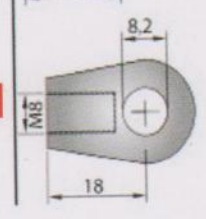

09-253-31

ORDER EXAMPLE	
0320203-10-27-750-275-350-002	
0320203	Rod connection end fitting
10	Rod diameter
27	Tube diameter
450	Force in Newtons
275	L1: Stroke in mm
350	L: Extended length in mm
002	Tube connection end fitting



2.6
14/27 STANDARD TYPE GAS SPRINGS

BOSFOR
GAS SPRINGS

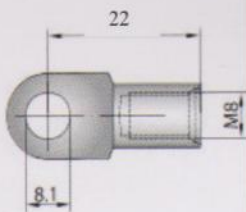
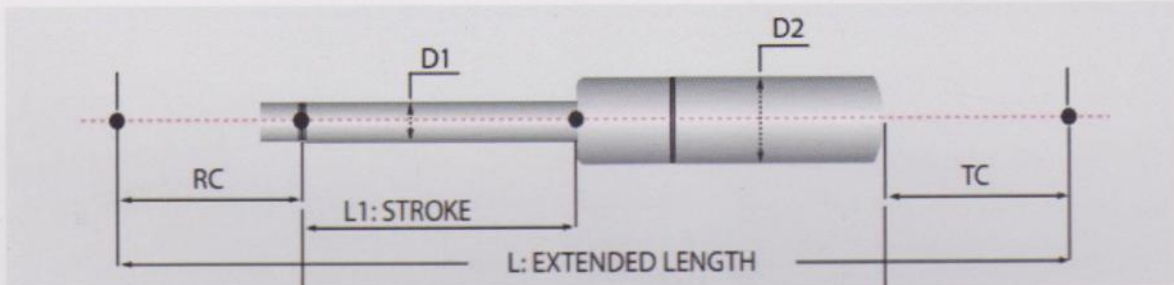

RC 14-103-01

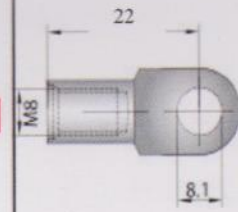

TC 14-103-01

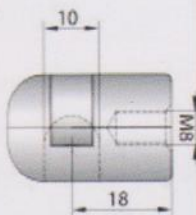

RC 03-202-03

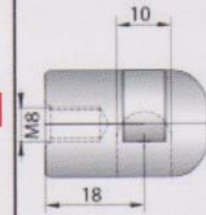

TC 03-202-03

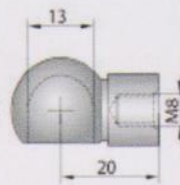

RC 13-108-01

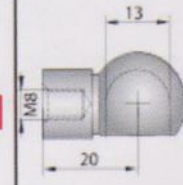

TC 13-108-01

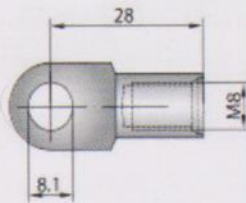

14-103-01

ORDER EXAMPLE	
0320203-14-27-750-275-350-002	
0320203	Rod connection end fitting
14	Rod diameter
27	Tube diameter
450	Force in Newtons
275	L1: Stroke in mm
350	L: Extended length in mm
002	Tube connection end fitting

002

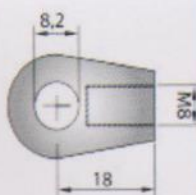
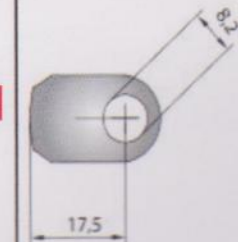

09-253-31

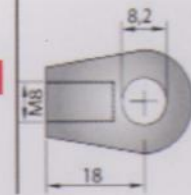

09-253-31



2.7 LOCKABLE TYPE GAS SPRINGS (ELASTIC)

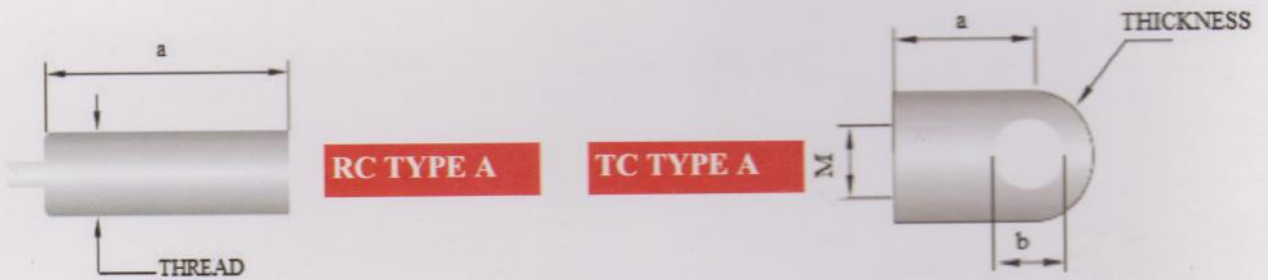
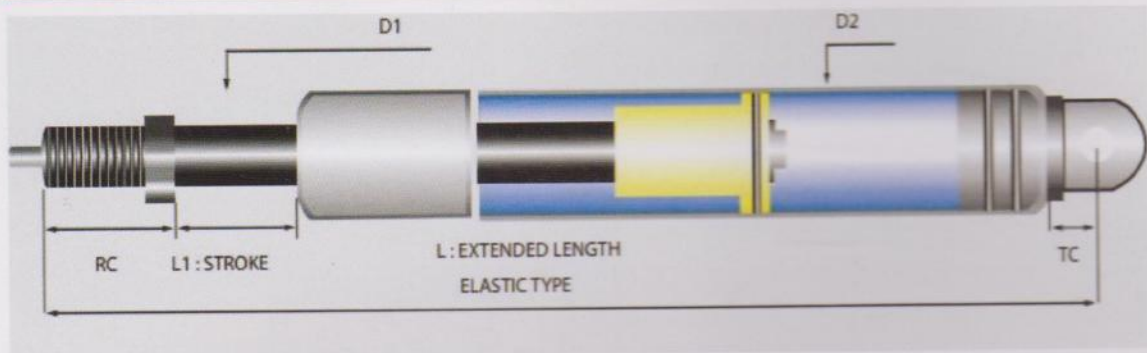

P/N	THREAD SIZE	a
RCA0	M8x1	16
RCA1	M10x1	18
RCA2	M14x1.5	20

THREAD SIZE	THICKNESS	a	b
8-10	5-8-10-12-14	15-17-20	8.2-10.2



P/N	THREAD SIZE	a
RCB0	M8x1	16
RCB1	M10x1	18
RCB2	M14x1.5	20

P/N	THREAD SIZE
TC0	M8
TC1	M10
Other type s of end fittings see below	



2.8 LOCKABLE TYPE GAS SPRINGS(RIGID)

BOSFOR
GAS SPRINGS

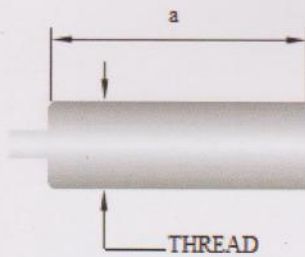
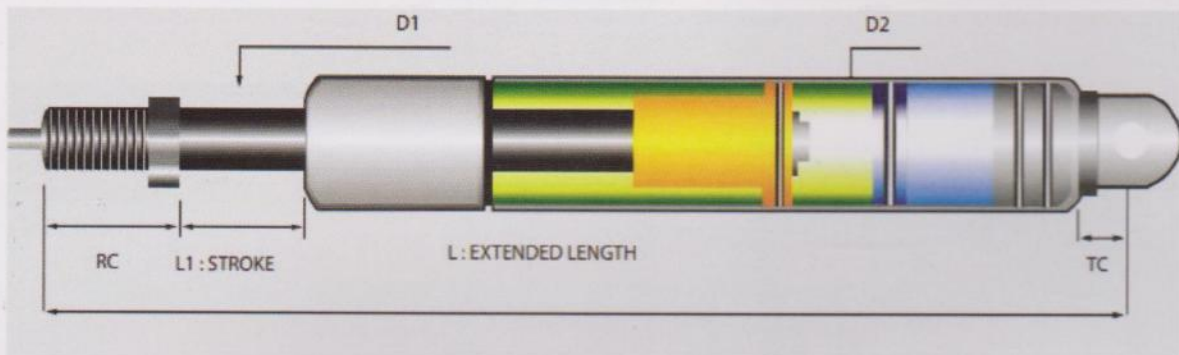

RC TYPE A

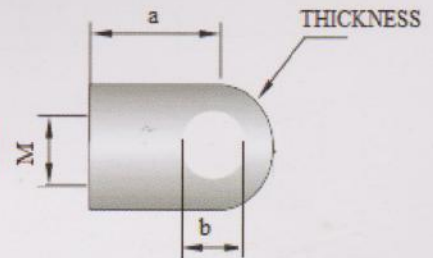

TC TYPE A

P/N	THREAD SIZE	a
RCA0	M8x1	16
RCA1	M10x1	18
RCA2	M14x1.5	20

THREAD SIZE	THICKNESS	a	b
8-10	5-8-10-12-14	15-17-20	8.2-10.2

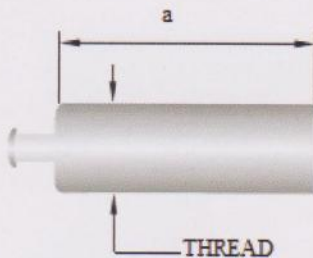

RC TYPE B

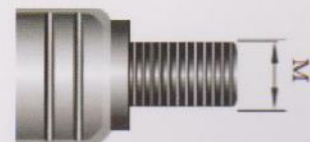

TC TYPE B

P/N	THREAD SIZE	a
RCB0	M8x1	16
RCB1	M10x1	18
RCB2	M14x1.5	20

P/N	THREAD SIZE
TC0	M8
TC1	M10
Other types of end fittings see below	

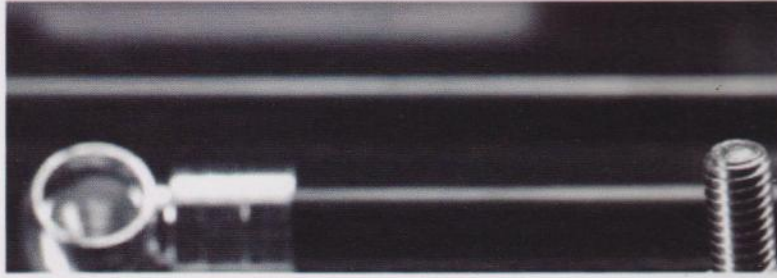

3.1 METAL END FITTINGS

BOSFOR
GAS SPRINGS

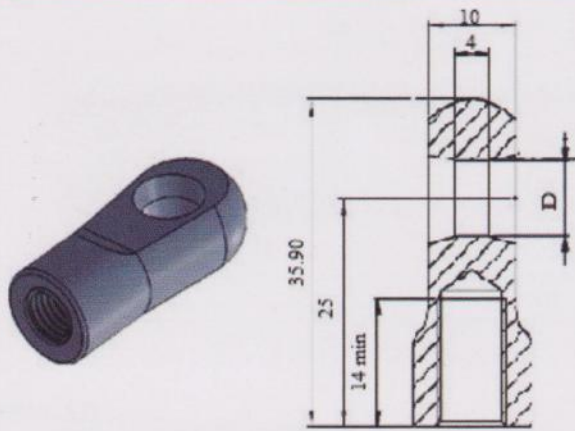

P/N	THREAD SIZE	D+0.1 mm
09-250-00	M6	6.1
09-250-01	M6	8.1
09-250-30	M8	6.1
09-250-31	M8	8.1

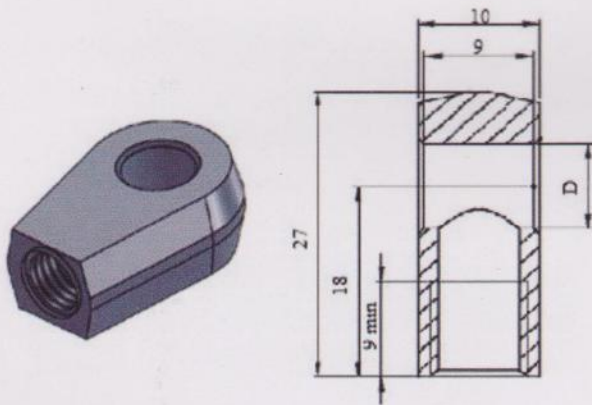

P/N	THREAD SIZE	D+0.1 mm
09-253-10	M6	6.1
09-253-11	M6	8.1
09-253-12	M6	10.1
09-253-30	M8	6.1
09-253-31	M8	8.1
09-253-32	M8	10.1

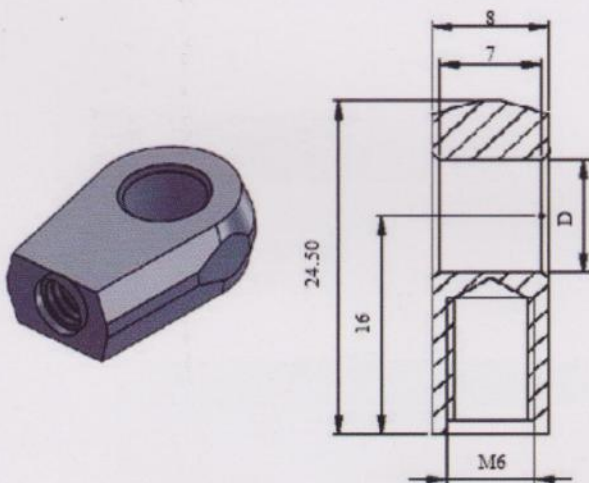

P/N	THREAD SIZE	D+0.1 mm
09-254-00	M6	6.1
09-254-01	M6	8.1



BOSFOR

GAS SPRINGS

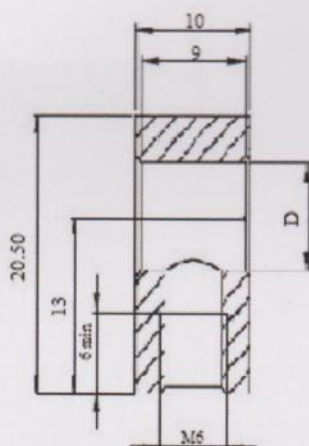

P/N	THREAD SIZE	D+0.1 mm
09-255-00	M6	6.1
09-255-01	M6	8.1

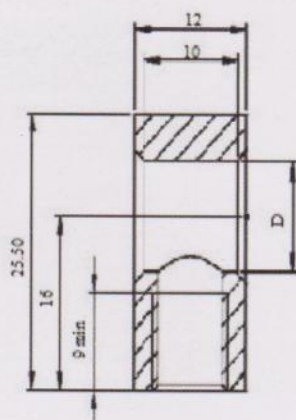
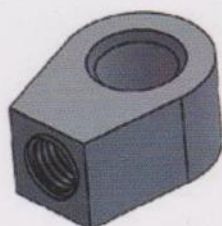

P/N	THREAD SIZE	D+0.1 mm
09-256-10	M6	8.1
09-256-11	M6	10.1
09-256-30	M8	8.1
09-256-31	M8	10.1
09-256-60	M10	8.1
09-256-61	M10	10.1

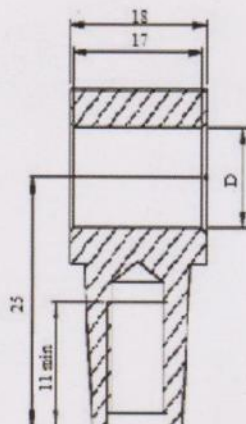

P/N	THREAD SIZE	D+0.1 mm
09-261-30	M8	8.1
09-261-31	M8	8.5
09-261-32	M8	10.1

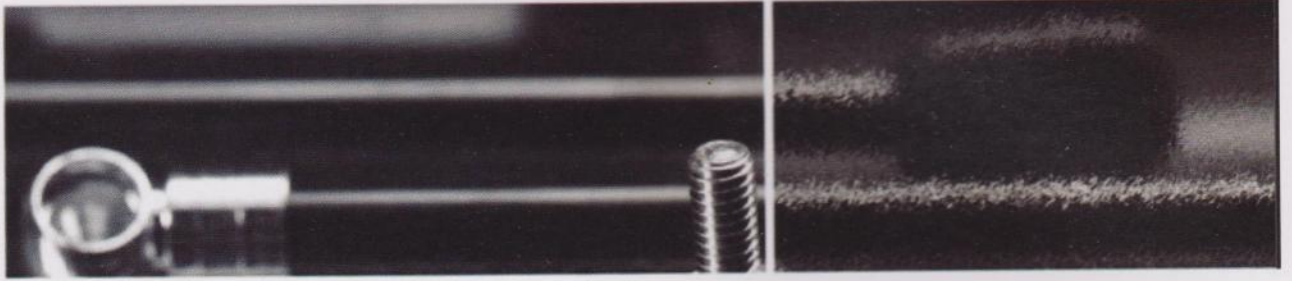

BOSFOR

GAS SPRINGS

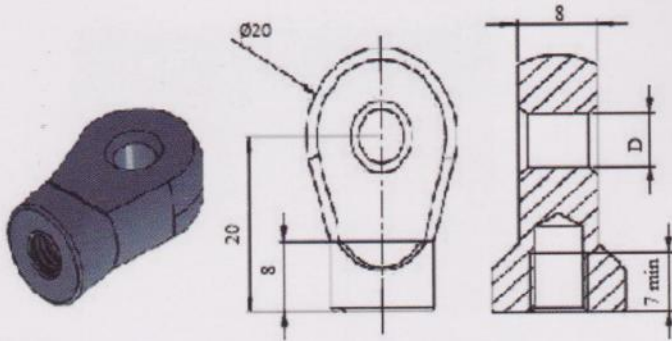

P/N	THREAD SIZE	D+0.1 mm
09-277-00	M6	6.1
09-277-01	M6	8.1
09-277-02	M6	10.1

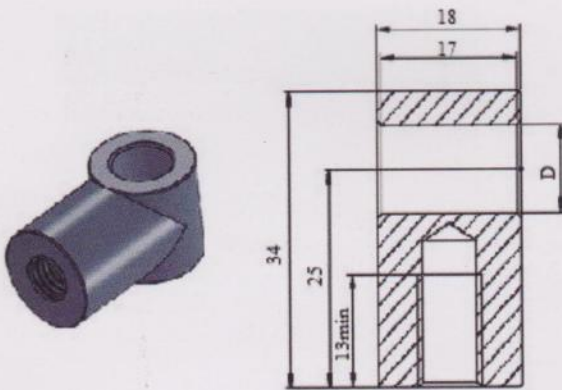

P/N	THREAD SIZE	D+0.1 mm
09-279-30	M8	8.1
09-279-31	M8	10.1
09-279-60	M10	8.1
09-279-61	M10	10.1

P/N 09-252-00

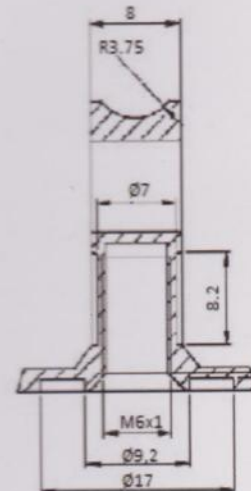
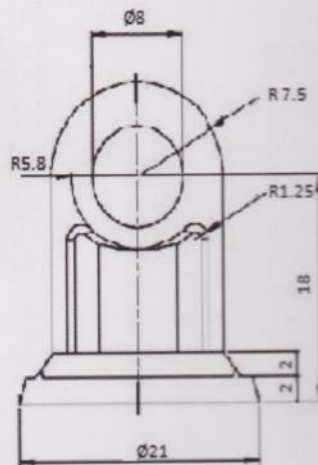
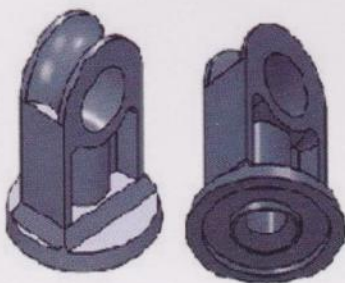



BOSFOR

GAS SPRINGS

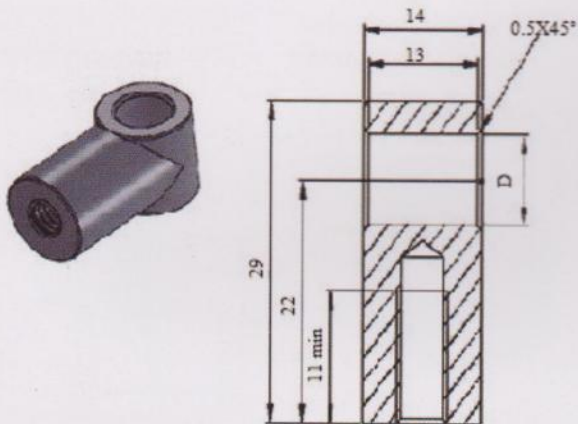

P/N	THREAD SIZE	D+0.1 mm
09-262-00	M6	6.1
09-262-01	M6	8.1
09-262-30	M8	6.1
09-262-31	M8	8.1

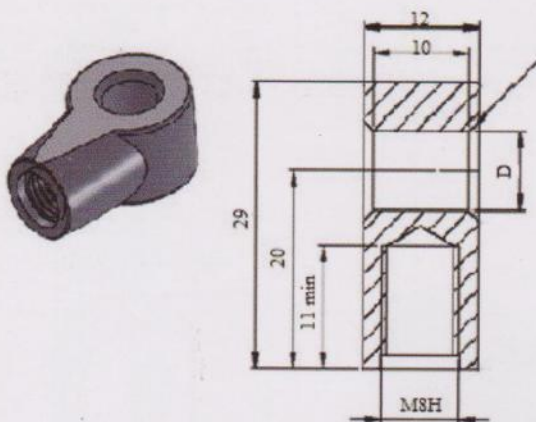

P/N	THREAD SIZE	D+0.1 mm
09-263-30	M8	8.1
09-263-31	M8	10.1

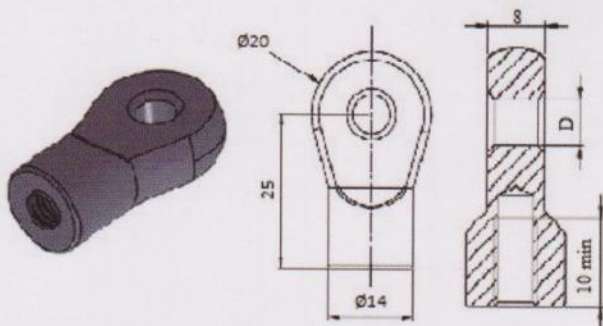

P/N	THREAD SIZE	D+0.1 mm
09-276-00	M6	6.1
09-276-01	M6	8.1
09-276-02	M6	10.1
09-276-30	M8	6.1
09-276-31	M8	8.1
09-276-32	M8	10.1

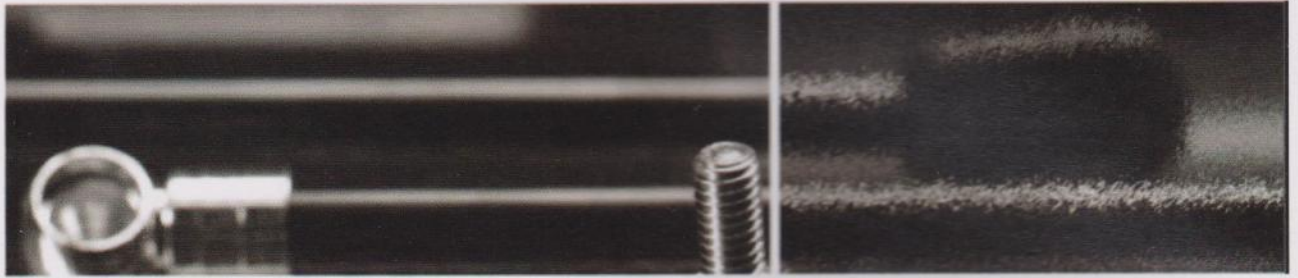

BOSFOR
GAS SPRINGS

P/N 09-257-00

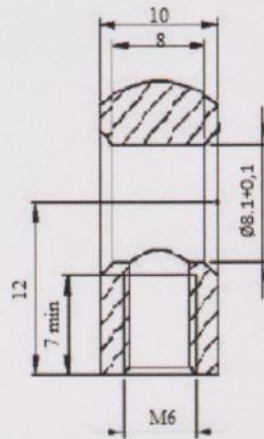

P/N 09-258-00

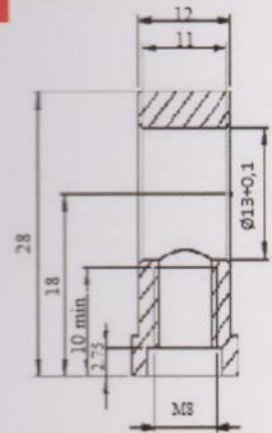
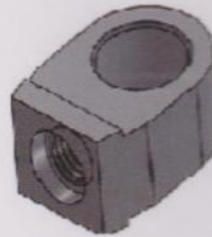

P/N 09-264-00

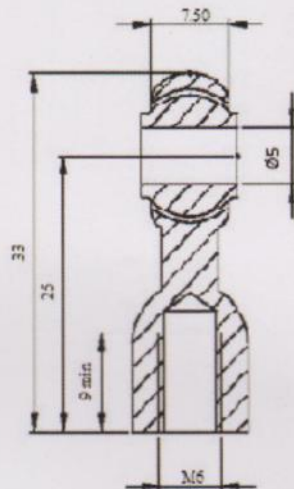

P/N 09-280-00

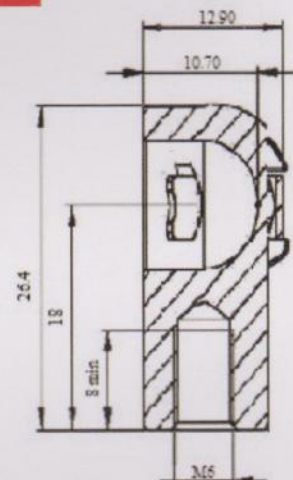



BOSFOR
GAS SPRINGS

P/N 09-271-00

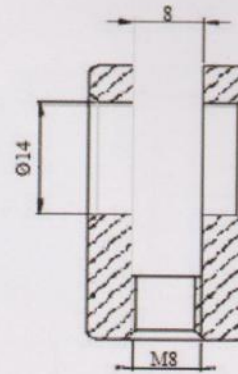
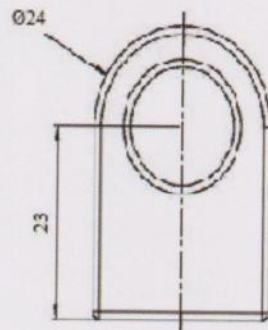

P/N 09-273-00

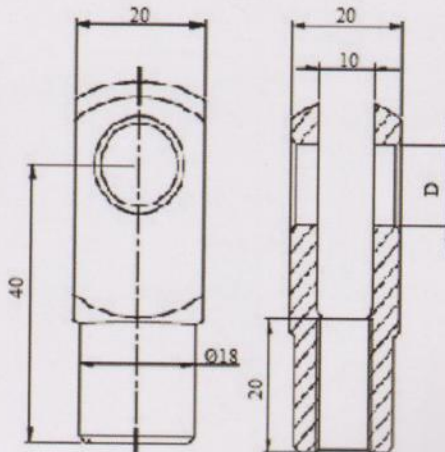
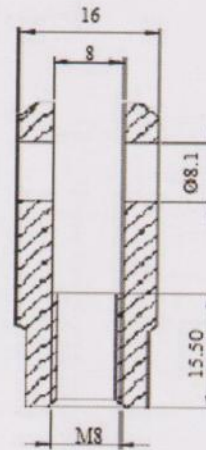
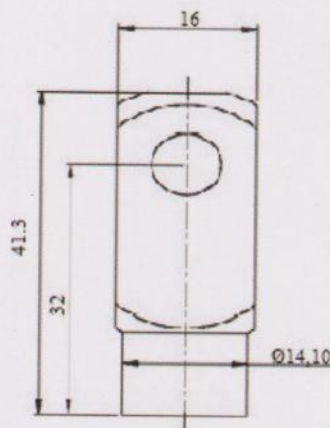

P/N	THREAD SIZE	D+0.1 mm
09-272-30	M8	8.1
09-272-31	M8	10.1
09-272-32	M8	12
09-272-60	M10x1	8.1
09-272-61	M10x1	10.1
09-272-61	M10x1	12

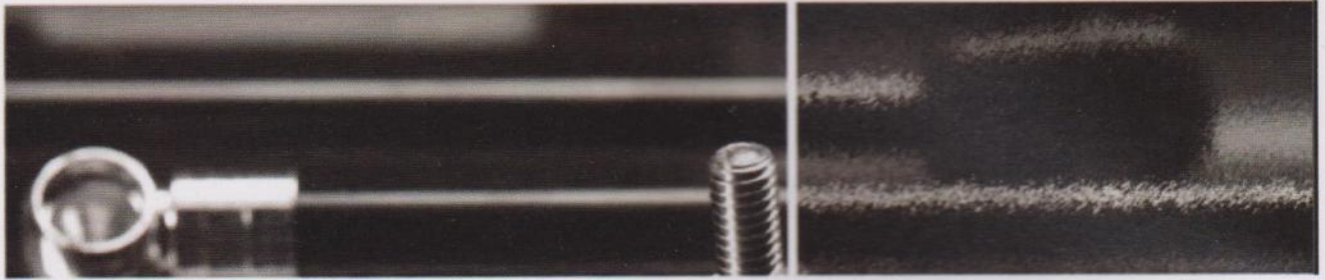

BOSFOR
GAS SPRINGS

P/N 05-112-00

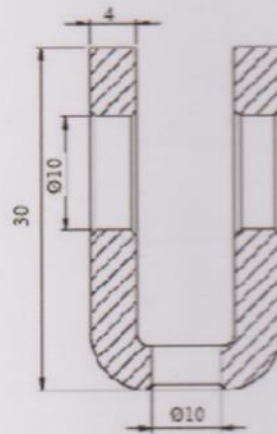
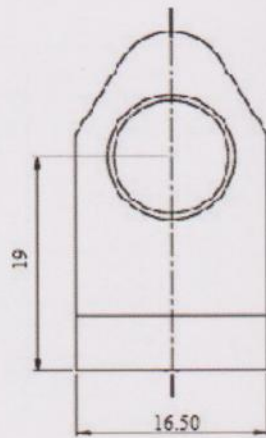
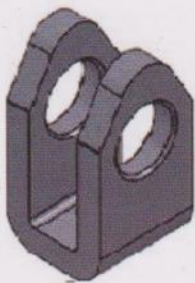

P/N 05-113-00

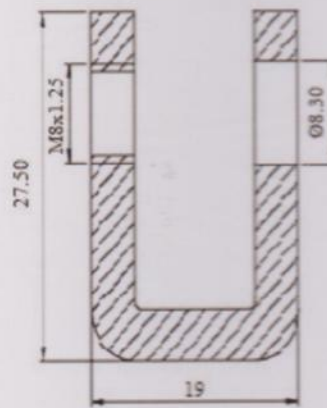
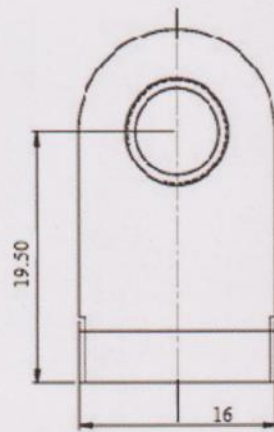

P/N 05-113-01

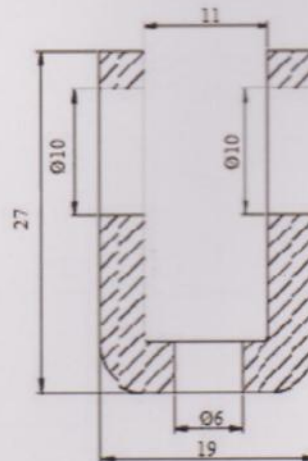
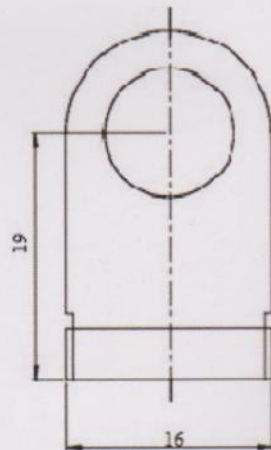

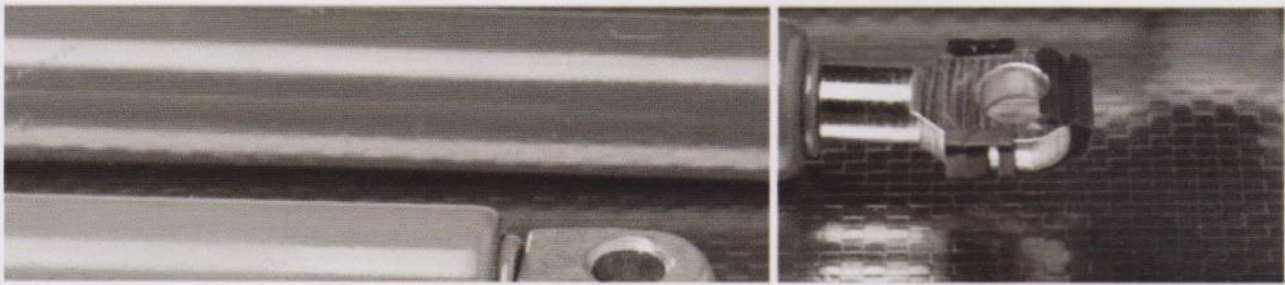

BOSFOR
GAS SPRINGS

P/N 05-114-00

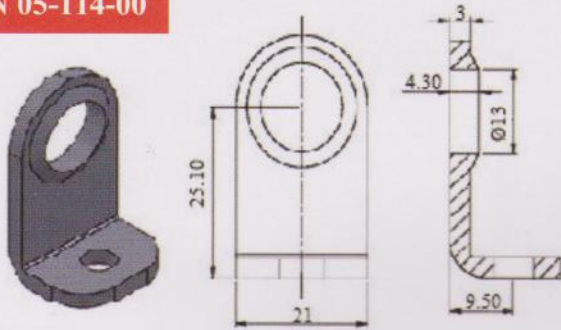

P/N 05-114-01

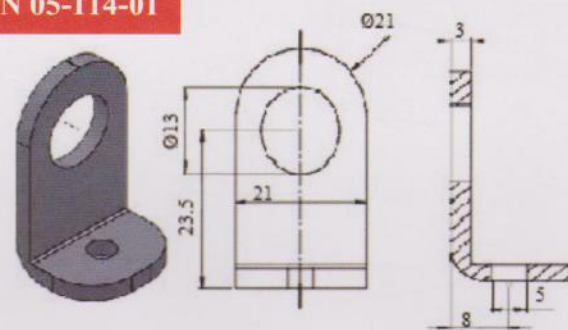

P/N 05-115-00

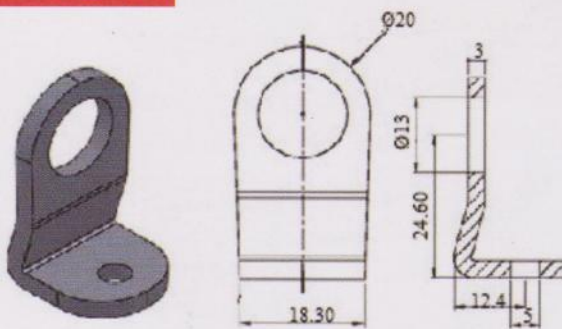

P/N 05-115-01

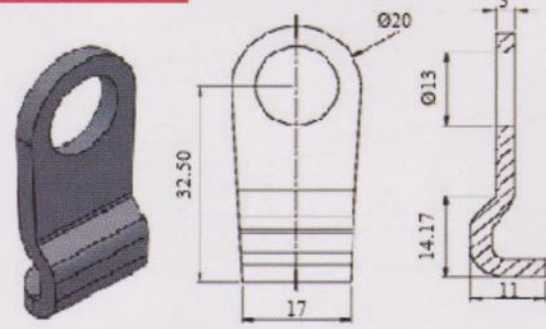

P/N 05-118-00

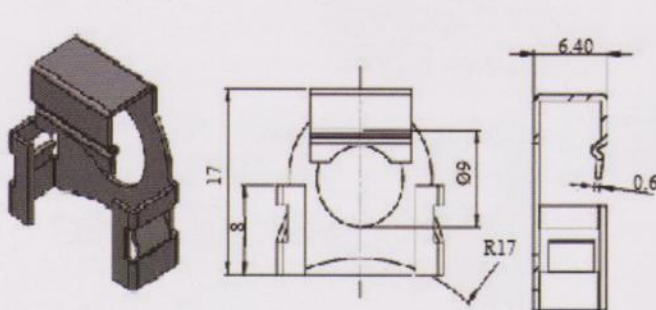

P/N 05-119-00

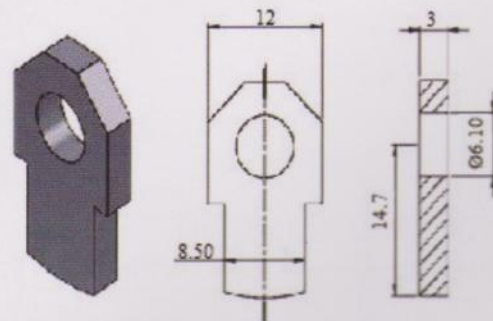

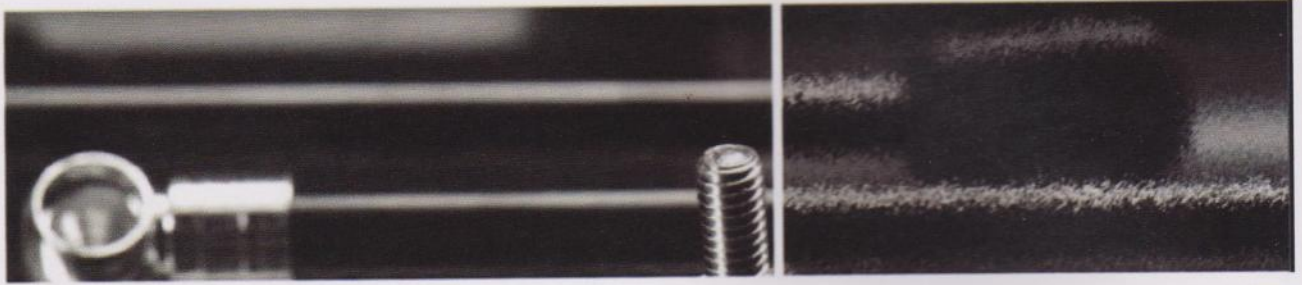

BOSFOR
GAS SPRINGS

M6 P/N 14-100-00
M8 P/N 14-100-01
M10 P/N 14-100-02

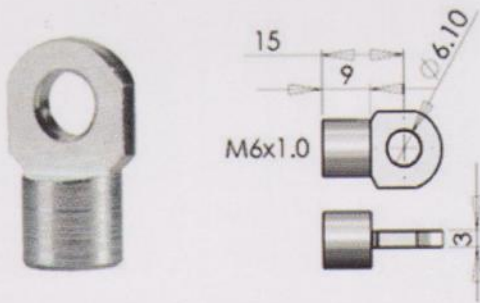

M6 P/N 14-101-00
M8 P/N 14-101-01
M10 P/N 14-101-02

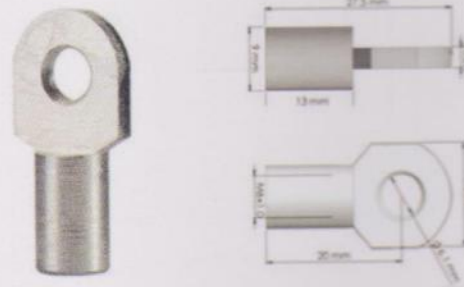

M6 P/N 14-102-00
M8 P/N 14-102-01
M10 P/N 14-102-02

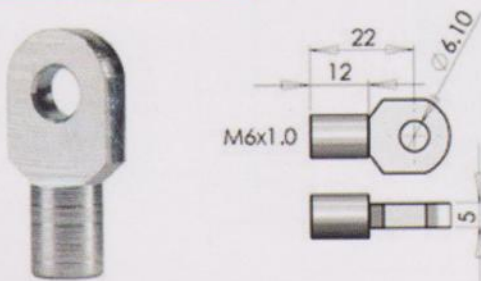

M6 P/N 14-105-00
M8 P/N 14-105-01
M10 P/N 14-105-02

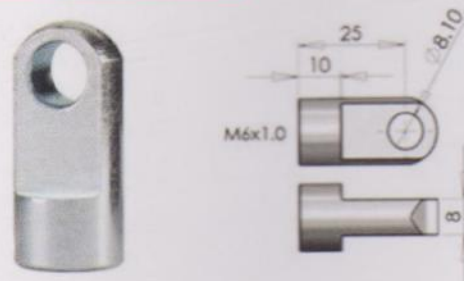

M6 P/N 14-104-00
M8 P/N 14-104-01
M10 P/N 14-104-02

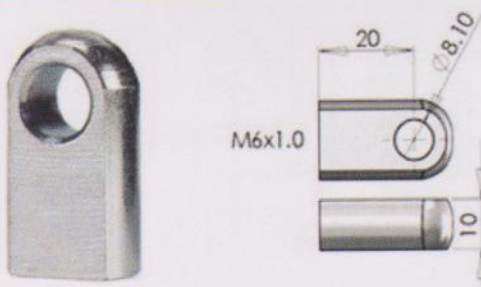

M6 P/N 14-103-00
M8 P/N 14-103-01
M10 P/N 14-103-02

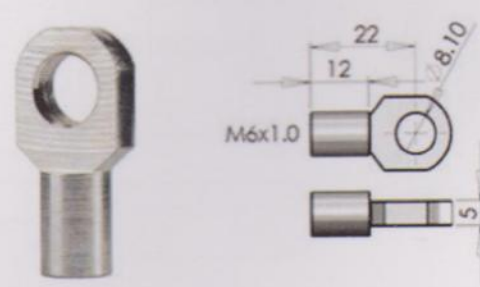

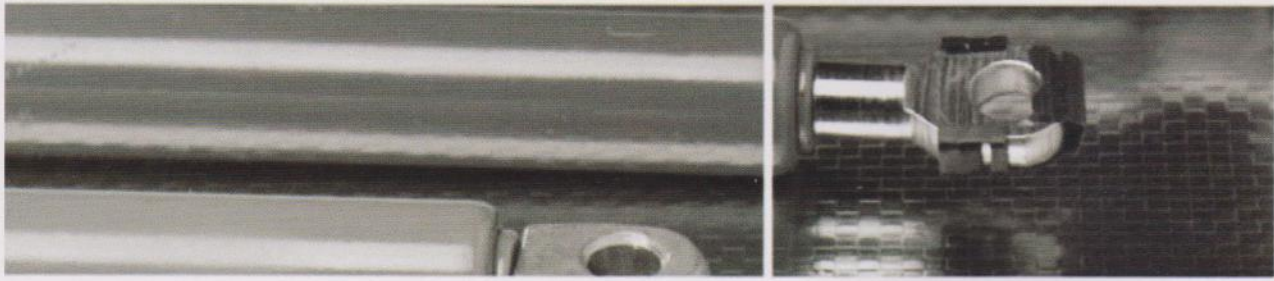

BOSFOR

GAS SPRINGS

P/N 13-106-00

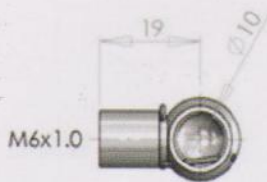

P/N 13-106-00

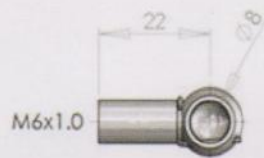

P/N 13-106-00



P/N 13-106-00



P/N 13-106-00



P/N 13-106-00

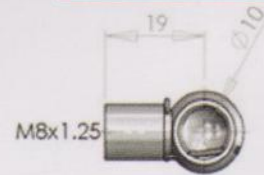

P/N 13-106-00



P/N 13-106-00

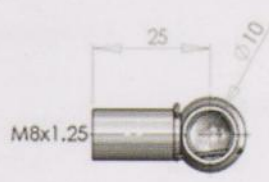

P/N 13-106-00



P/N 13-106-00



P/N 13-106-00



P/N 13-106-00





3.2 PLASTIC END FITTINGS

BOSFOR
GAS SPRINGS

P/N 03-200-01

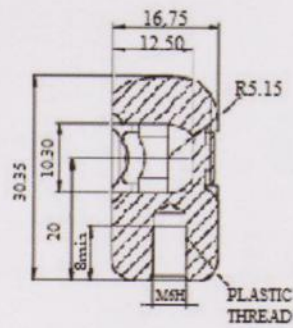

P/N 03-210-04

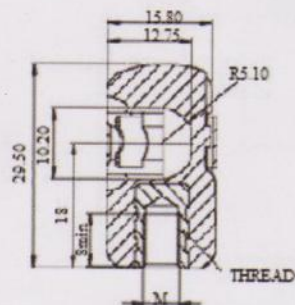
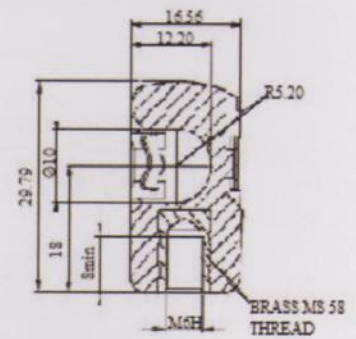

P/N	THREAD	THREAD MATERIAL
03-200-02	M6H	ZAMAK5
03-200-03	M6H	CARBON STEEL
03-202-03	M8H	CARBON STEEL

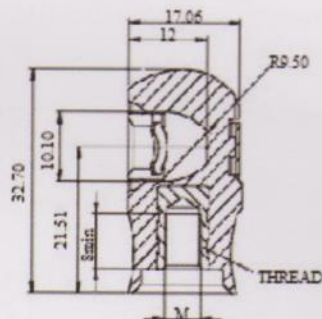

P/N	THREAD SIZE	THREAD MATERIAL
03-230-02	M6H	ZAMAK5
03-230-03	M6H	CARBON STEEL
03-232-03	M8H	CARBON STEEL



BOSFOR

GAS SPRINGS

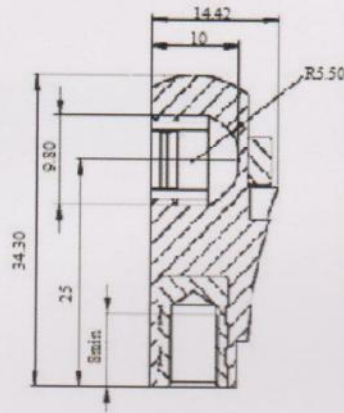

P/N	THREAD SIZE	THREAD MATERIAL
03-250-02	M6	ZAMAK5
03-250-03	M6	CARBON STEEL
03-252-03	M8	CARBON STEEL

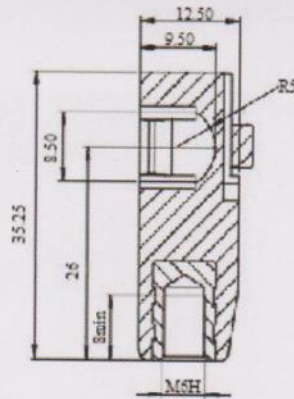
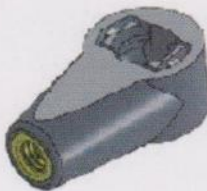

P/N	THREAD SIZE	THREAD MATERIAL
03-260-02	M6	ZAMAK5
03-260-03	M6	CARBON STEEL

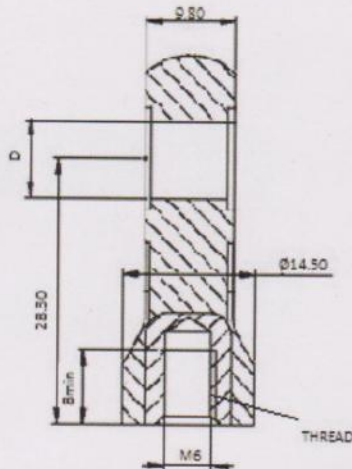

P/N	D	THREAD MATERIAL
03-290-01	10.10	PLASTIC
03-290-02	10.10	ZAMAK5
03-290-03	10.10	CARBON STEEL
03-300-01	8.40	PLASTIC
03-300-02	8.40	ZAMAK5
03-300-03	8.40	CARBON STEEL

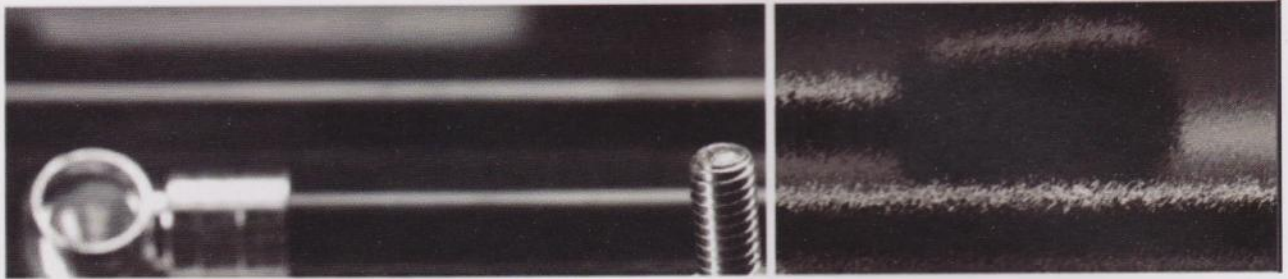

BOSFOR
GAS SPRINGS

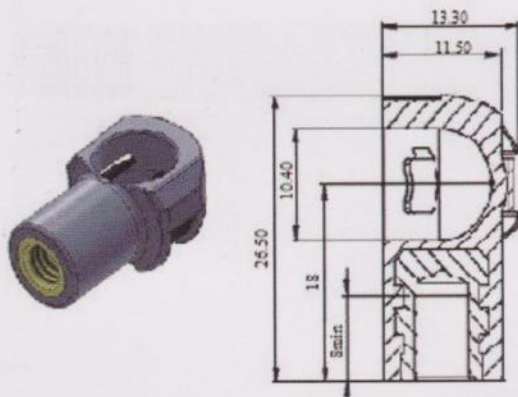

P/N	THREAD SIZE	THREAD MATERIAL
03-360-02	M6	ZAMAK5
03-360-03	M6	CARBON STEEL
03-360-04	M6	BRASS MS 58

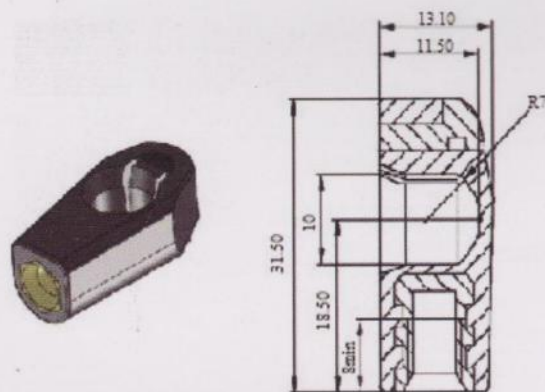

P/N	THREAD SIZE	THREAD MATERIAL
03-310-01	M6	PLASTIC
03-310-02	M6	ZAMAK 5
03-310-04	M6	BRASS MS 58

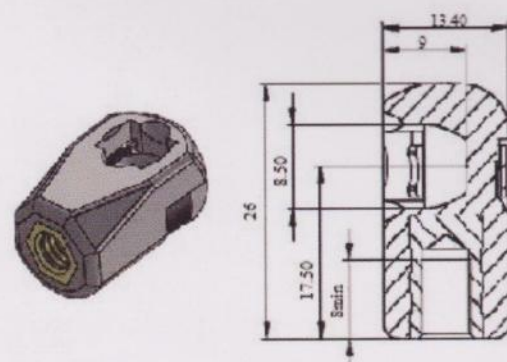

P/N	THREAD SIZE	THREAD MATERIAL
03-320-01	M6	PLASTIC
03-320-02	M6	ZAMAK 5
03-320-03	M6	CARBON STEEL



BOSFOR

GAS SPRINGS

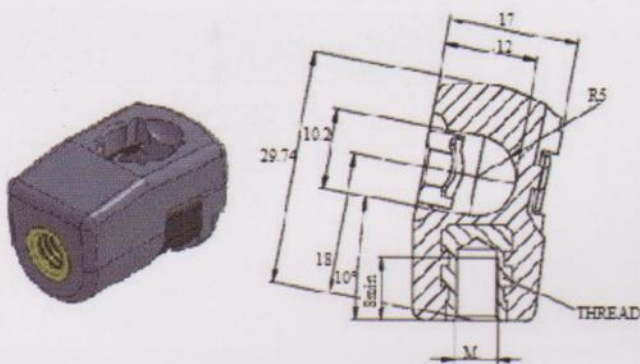

P/N	THREAD SIZE	THREAD MATERIAL
03-340-02	M6	ZAMAK5
03-340-04	M6	BRASS MS 58
03-342-03	M8	CARBON STEEL

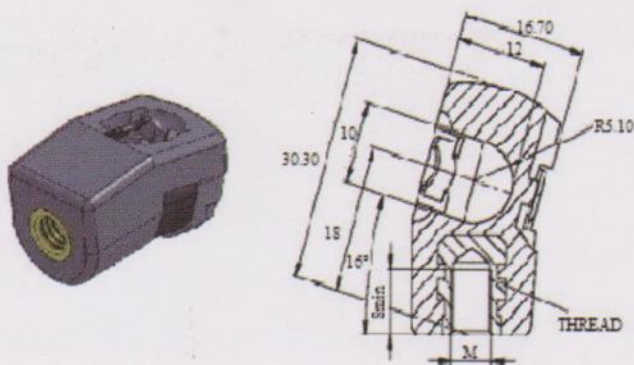

P/N	THREAD SIZE	THREAD MATERIAL
03-350-02	M6	ZAMAK5
03-350-03	M6	CARBON STEEL
03-350-04	M6	BRASS MS 58
03-352-03	M8	CARBON STEEL

P/N 03-240-02

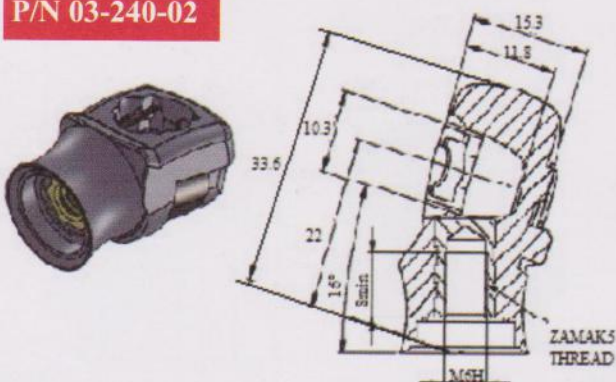

P/N 03-270-02

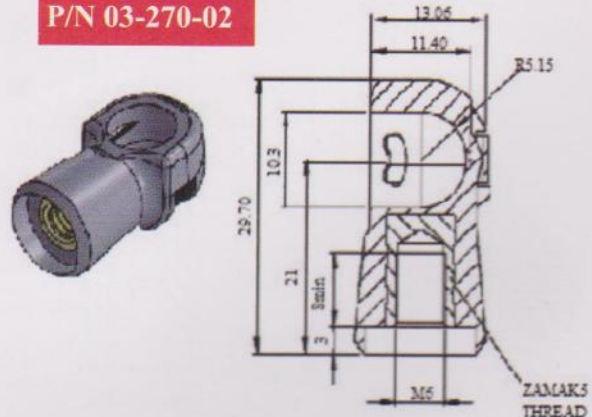

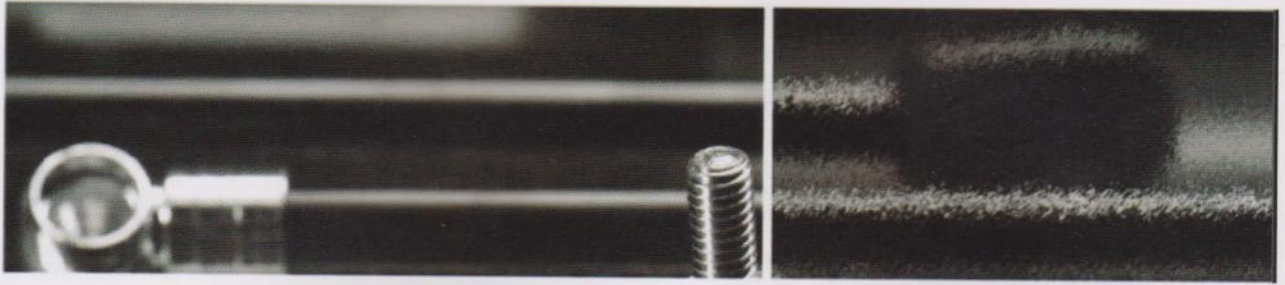

BOSFOR

GAS SPRINGS

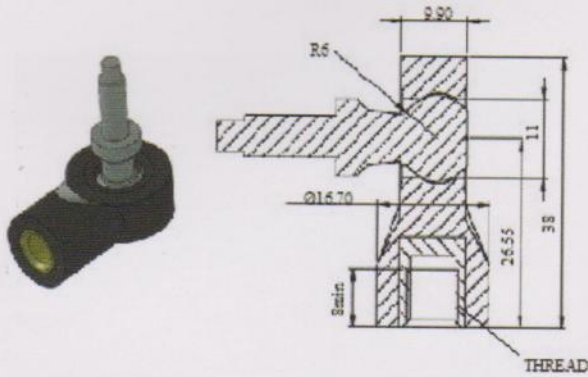

P/N	THREAD SIZE	THREAD MATERIAL
03-280-02	M6	ZAMAK5
03-280-03	M8	CARBON STEEL

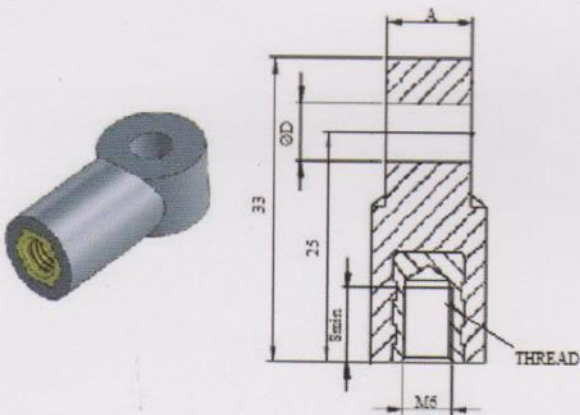

P/N	A	D	THREAD MATERIAL
03-500-02	10	6	ZAMAK5
03-500-03	10	6	CARBON STEEL
03-500-04	10	6	BRASS MS 58
03-510-02	14	8.5	ZAMAK5
03-510-03	14	8.5	CARBON STEEL
03-510-04	14	8.5	BRASS MS 58
03-520-02	10	8.5	ZAMAK5
03-520-03	10	8.5	CARBON STEEL
03-520-04	10	8.5	BRASS MS 58

P/N 03-214-00

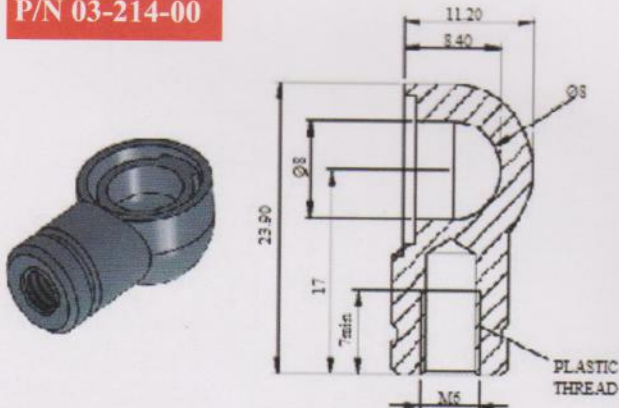

P/N 03-209-00

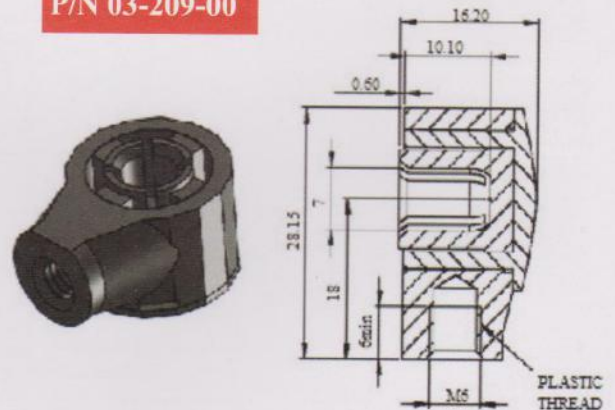

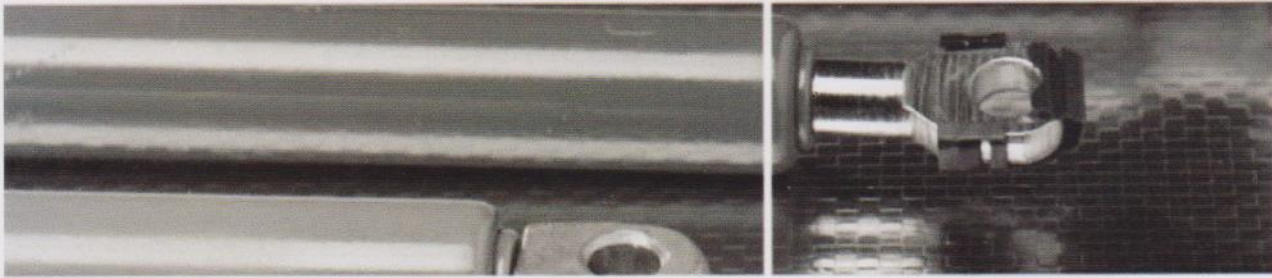

BOSFOR

GAS SPRINGS

P/N 03-900-01

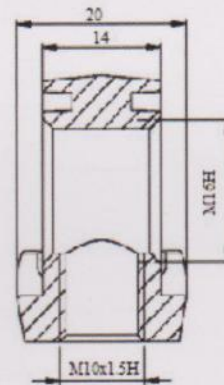
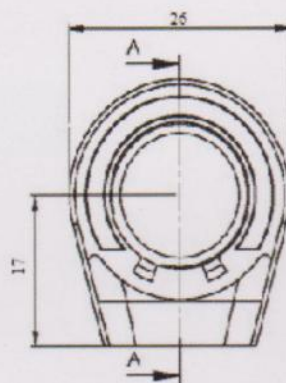
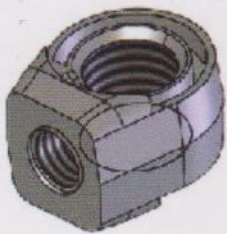

P/N 03-216-00

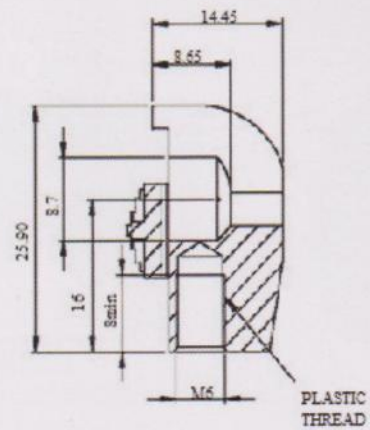
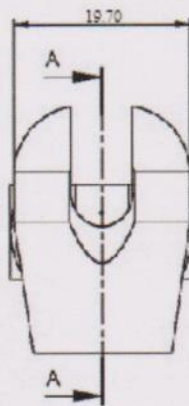
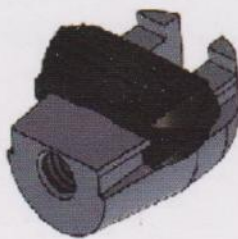

P/N 03-225-00

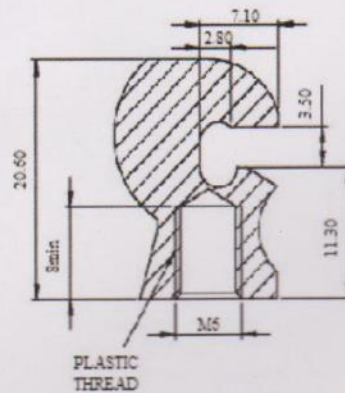

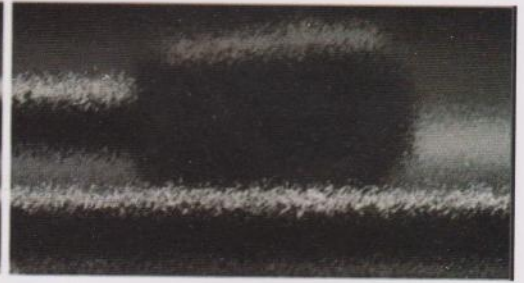
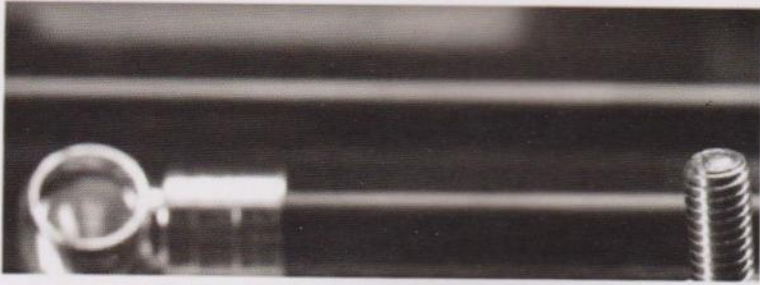

3.3 MECHANISMS FOR LOCKABLE TYPE GAS SPRINGS

BOSFOR
GAS SPRINGS

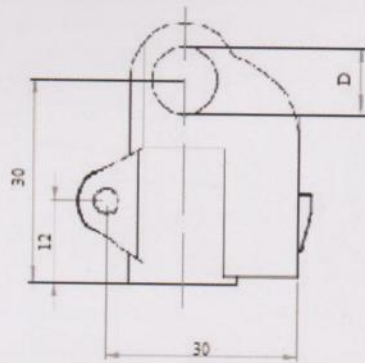
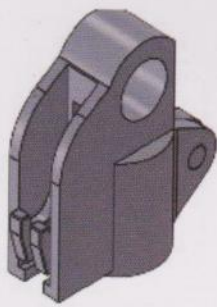

P/N	THREAD SIZE	D+0.1 mm
09-266-30	M8	8.1
09-266-31	M8	10.1
09-266-60	M10x1	8.1
09-266-61	M10x1	10.1

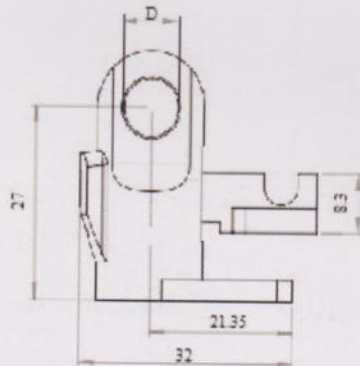
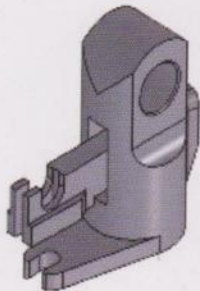

P/N	THREAD SIZE	D+0.1 mm
09-268-30	M8	8.1
09-268-31	M8	10.1
09-268-60	M10x1	8.1
09-268-61	M10x1	10.1

P/N 09-267-60

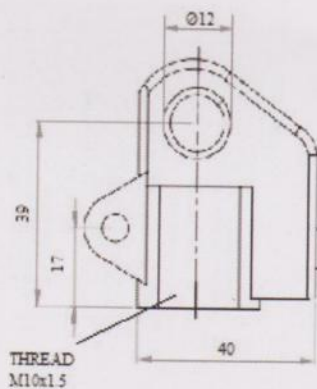
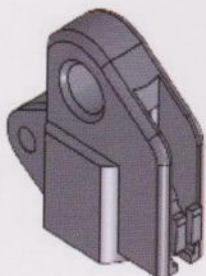

P/N 09-269-60

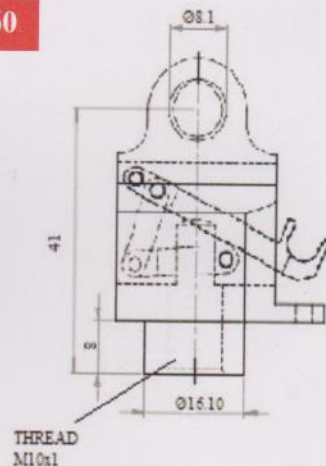
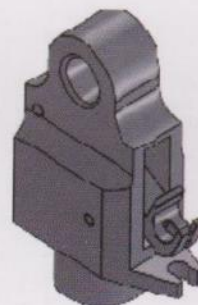

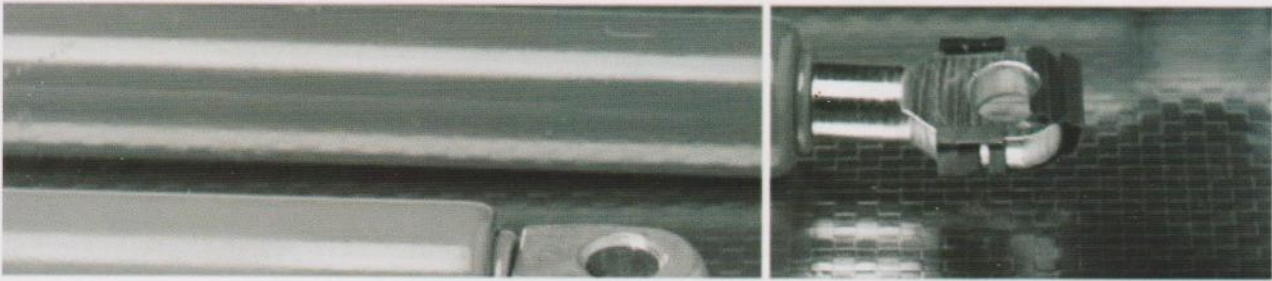

BOSFOR
GAS SPRINGS

PUSH BUTTON

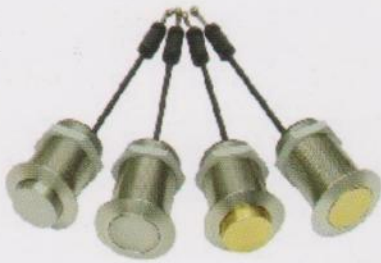

PEDAL

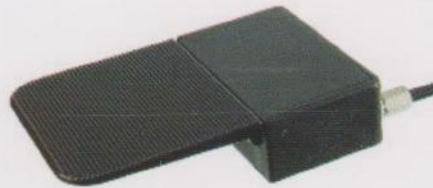

LEVER 1



LEVER 2



LEVER 3

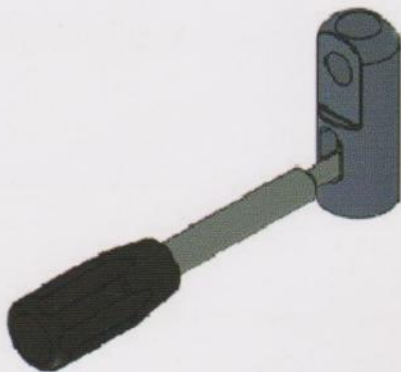

LEVER 4

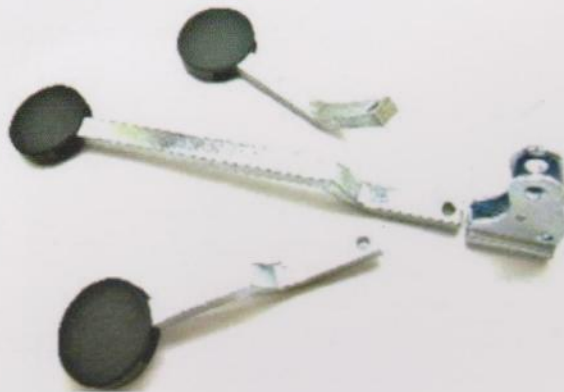



BOSFOR

GAS SPRINGS

Bosfor Amortisör Makina Sanayi ve Ticaret A.Ş.

Tel: +90 212 549 76 44 / FAX: +90 212 549 76 45

İmrahor Mah. Sevban Mehmet Cad. No 126-128-130

34275 Arnavutköy—İstanbul / Turkey